

MERRITT SELECT SPARE PARTS

(FORMERLY FSA/FSAD & LFC/LRC)

Stationary base model with fixed consoles shown
(former LFC models)

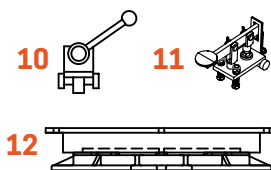
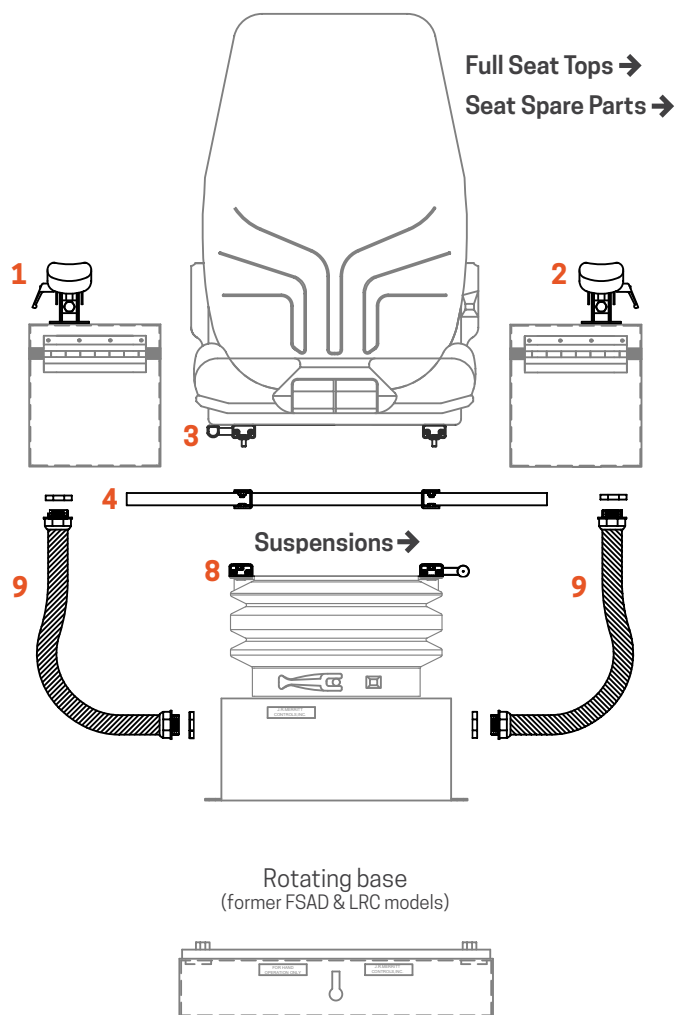

ITEM	PART #	DESCRIPTION	
1	07.064.04	Right-hand console-mounted armrest	→
2	07.064.02	Left-hand console-mounted armrest	→
3	07.751.1	Actimo seat slide with handle	→
4	07.718	Fixed console carrier (frame only)	→
	70.096	Fixed console carrier assembly w/ carrier slide & console brackets	→
5	07.719	Flip-up console carrier (frame only)	→
	70.095	Flip-up console carrier assembly w/ carrier slide, console brackets, knobs, & gas struts	→
6	07.116	Console flip-up / tilt adjustment knob	→
7	70.231	Gas strut for flip-up consoles	→
8	07.751	Carrier slide with handle	→
9	70.706	Flex tube kit w/ two (2) fittings & two (2) nuts	→
10	07.126-01	Friction brake handle assembly	→
11	70.143	Pinlock brake handle assembly	→
12	07.537	Pinlock rotator and flange assembly	→
	07.538	Friction brake rotator and flange assembly	→
13	07.144	Fixed right-hand footrest (hardware not included)	→
14	07.143	Fixed left-hand footrest (hardware not included)	→
15	70.099	Fixed footrest kit (includes left/right footrests, supports & hardware)	→