

NS2-KB / NSB2-KB JOYSTICK

One axis, rugged, heavy duty vertical cast masterswitch that is characterized by its robust construction for step and stepless AC & DC controls. Features a rectangular shaped cast body and popular mounting hole pattern allowing for easy replacement of other manufacturer's master switches.



SPECIFICATIONS

GENERAL DATA

# of Axis	Single
Output Options	Contacts, Potentiometer, Encoder, 4-20mA & Transformer
Joystick Action	Spring Return
Handle Travel	+/- 40 degrees each axis
Max # of Steps	Up to 7-0-7
Handle Compatibility	Standard Handles, Push Button, Mechanical Interlock, RH, BH, MG27
Life	20 million cycles
Materials	Cast aluminum housing with self lubricating bearings, brass cam shaft, and stainless steel gate.
Est. Shipping Weight	14 lbs.

Est. Shipping Dimensions 24 in. x 12 in. x 12 in.

MOUNTING DATA

Mounting Style Drop-in

Mounting Footprint 6.5" x 6.5"
See literature for additional mounting specifications

ENVIRONMENTAL DATA

IP Rating IP65

Operating Temperature -4 to +140 degrees F [-20 to +60 degrees C]

ELECTRICAL DATA

Switch Type:
Double Pole Contact Blocks

Max. Number:
Up to 5 contact blocks (10 circuits)

Max. Switching Capacity:
Making - 160 amps
Breaking - (0.7PF) 240V 160 amps

Contact Specifications

Rating (AC) NS2-KA:
Continuous 25 amps @ 600V
Resistive 20 amps @ 240V
Inductive 14 amps @ 240V

Rating (DC) NSB2-KB:
Resistive 5 amps @ 250V
Inductive 2 amps @ 250V

Termination:
Saddle Clamp

Max. Wire Size:
12 AWG

Additional
Specifications

Reference product literature for additional specifications

Technical Drawings

Dimensional

All dimensions in inches [mm] and are subject to change.

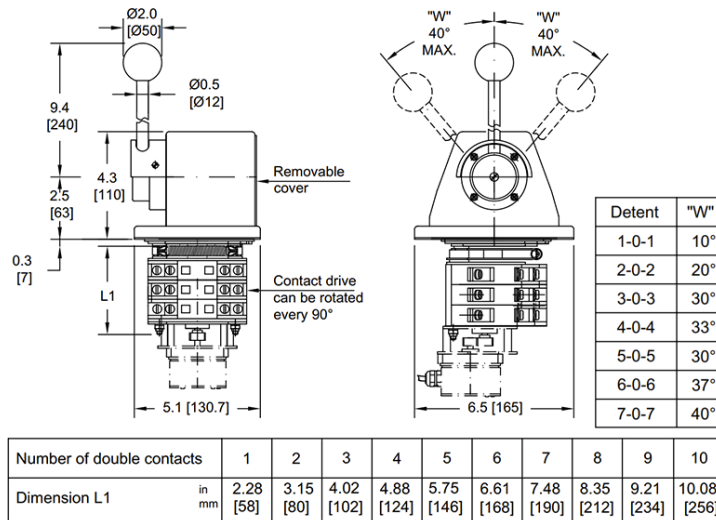

Overall dimensions. Shown with round ball handle

Mounting

All dimensions in inches [mm] and are subject to change.

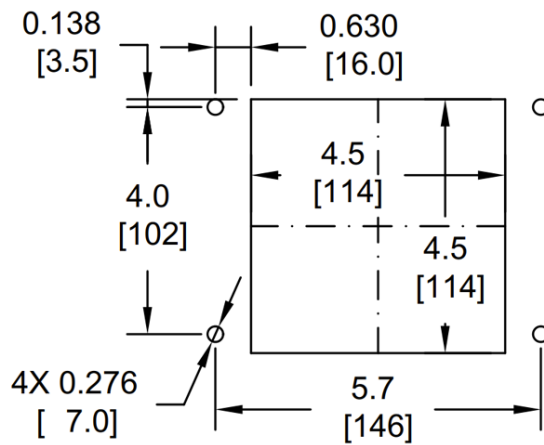

Panel mounting details